

## General characteristics

### E125

No. of poles	1 Form C (1PDT)
Volume	3.3 cm <sup>3</sup> [.52 in <sup>3</sup> ]
Mass	41 grams [.09 lb. Max]

## Switching characteristics

Operate time @ 25° C	with DC	10 ms max.
	with AC	20 ms max.
Release time @ 25° C	with DC	10 ms max.
	with AC	50 ms max.
Bounce time @ 25° C	with DC	1 ms max.
	with AC	2 ms max.

Mechanical Life 400,000 cycles

Contact rating	Type of load (High level)	cycles x 10 <sup>3</sup>	28 Vdc	115 Vac 400 Hz 1 phase	115 Vac 50/60 Hz 1 phase
Resistive		50	25 amps	25 amps	n/a
Resistive		25	n/a	n/a	10 amps
Inductive		10	12	n/a	n/a
Inductive		20	n/a	15 amps	n/a
Inductive		25	n/a	n/a	10 amps
Motor		50	10 amps	10 amps	n/a
Motor		25	n/a	n/a	8 amps
Lamp		50	5 amps	5 amps	n/a
Overload current		n/a	50 amps	80 amps	n/a
Rupture current		n/a	60 amps	100 amps	n/a

## Environmental characteristics

Temperature Range	-70°C to +125°C
Vibration (Sinusoidal)	30 g 10-3000 Hz
Shock, any axis	200 g 6 ms
Seal	Hermetic (1 x 10 <sup>-8</sup> atm cm <sup>3</sup> /s)

## Electrical characteristics

Contact voltage drop (@ Rated resistive load)	
- Initial	150 mV Max.
- After guaranteed life	175 mV Max.

Dielectric strength @ sea level	Coil to Case	All other points
	1000 Vrms	1250 Vrms
	1000 Vrms	1000 Vrms

Insulation Resistance	
- Initial	100 Megohms min. @ 500 Vdc
- After life tests	50 Megohms min. @ 500 Vdc

Reference Military Specifications	MIL-PRF-83536
Mating Socket Reference	MIL-PRF-12883

# E S 125 E 2 M D

**RELAY TYPE**

'E' Series

**OPTIONAL**

'S' = Internal Voltage suppressor

'A' = AC Coil

**MODEL**

**125:** 1PDT, 25 Amps

**COIL CODE**

**125:** See Page 4

**MOUNTING STYLES**

**125:** See Page 5

**TERMINAL STYLE AND FINISH**

**125:** See Page 6

'D' FOR CATALOG STANDARD OR

'XXXX' FOR SPECIAL INSTRUCTIONS OR SPECIFICATIONS

(ASSIGNED BY DRI)

## Coil Characteristics

COIL CODE	DC						AC	
	A	B	D	E	G	J	L	N
Nominal coil voltage	6	12	26,5	28	48	110	115-400 Hz	115-50/60/400 Hz
Maximum pick-up voltage at 25°C	3,2	6,5	13,5	14	24	55	72	72
Maximum pick-up voltage at 125°C	4,5	9,0	18	18,7	36	70	90	90
Minimum drop-out voltage at -70° C	0,25	0,5	1,2	1,5	2	5	5	5
Coil resistance ( ohms ± 10% at 25°C )	20	80	320	320	955	5000	-	-
Maximum coil transient suppression (where applicable) VDC	-42	-42	-42	-42	-100	-180	-	-

OTHER VOLTAGES AVAILABLE FROM FACTORY ON REQUEST

## Circuit Diagram

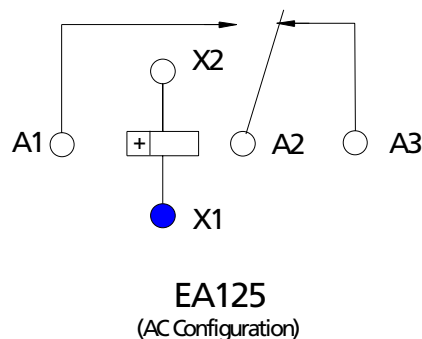
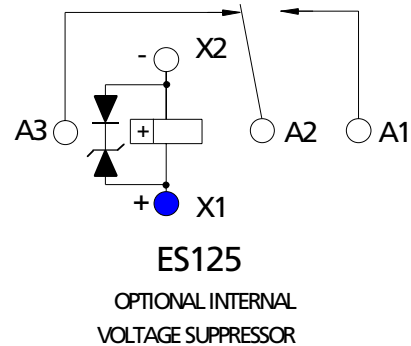
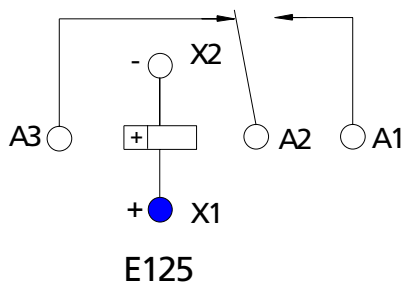

## ■ Mounting styles

DIMENSIONS ARE IN MM (IN.)  
UNLESS OTHERWISE SPECIFIED, TOLERANCE IS  $\pm 0,25$  [.010]

"A" Dimension: DC coil: 25,65 [1.010]  
AC coil: 28,58 [1.125]

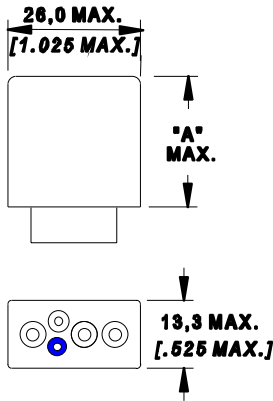

**STYLE 1**  
NO MOUNT

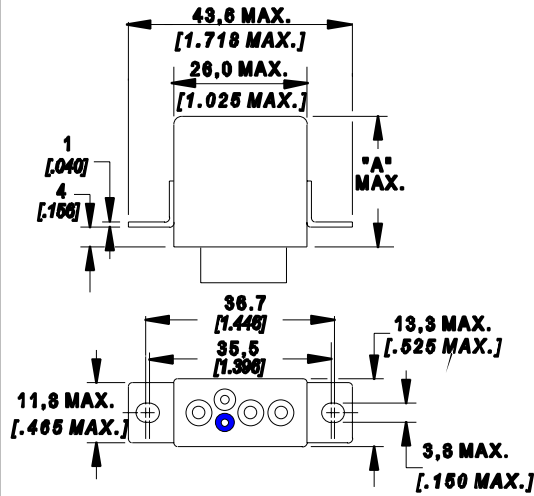

**STYLE 2**  
RAISED VERTICAL FLANGE MOUNT

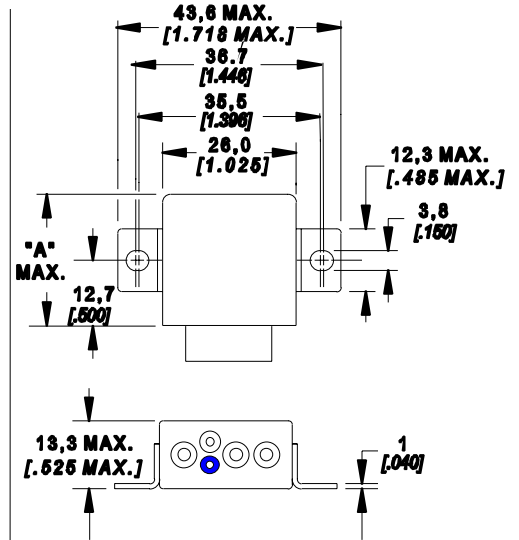

**STYLE 3**  
HORIZONTAL FLANGE MOUNT

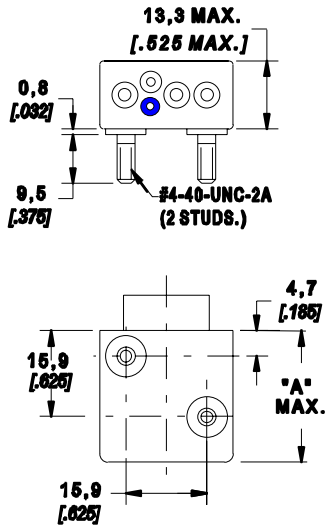

**STYLE D**  
SIDE STUD

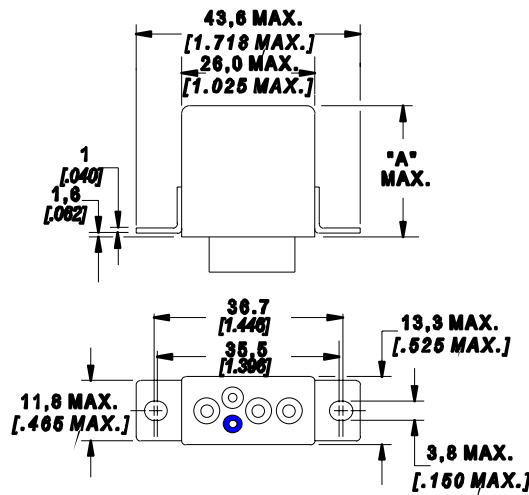

**STYLE N**  
VERTICAL FLANGE MOUNT

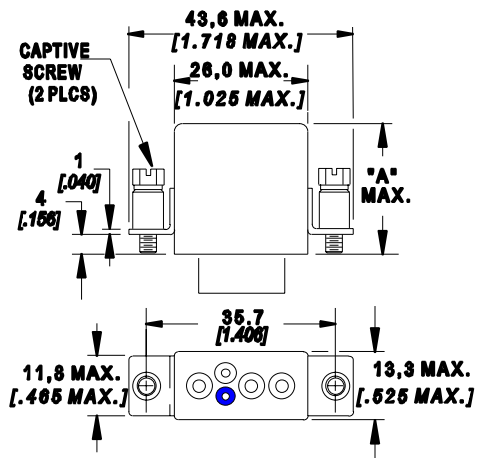

**STYLE 8:** M3 CAPTIVE SCREWS  
**STYLE C:** #4-40 UNC CAPTIVE SCREWS

RAISED VERTICAL FLANGE MOUNT  
WITH CAPTIVE HARDWARE

## Termination Styles (cont.)

DIMENSIONS ARE IN MM (IN.)  
UNLESS OTHERWISE SPECIFIED, TOLERANCE IS  $\pm 0,25$  [.010]

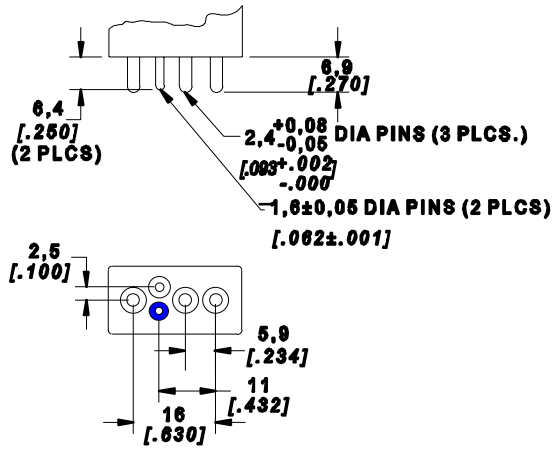

**SOLDER PIN**

STYLE A: TIN PLATED

STYLE B: SOLDER DIPPED

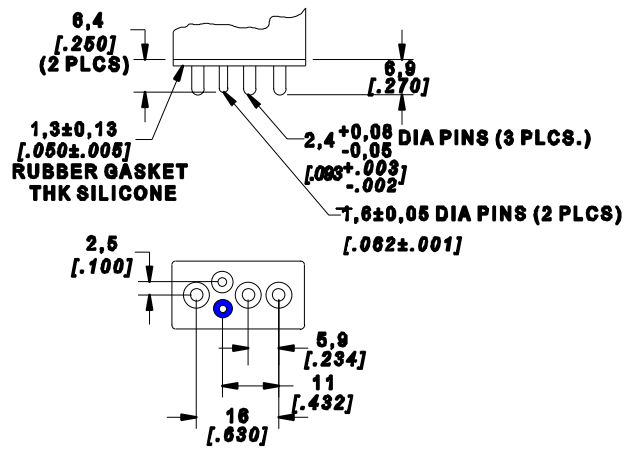

**PLUG IN (DC or AC)**

STYLE C: GOLD PLATED

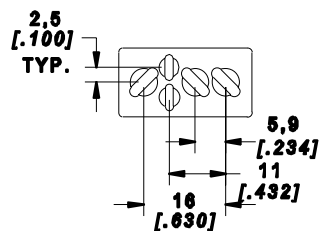
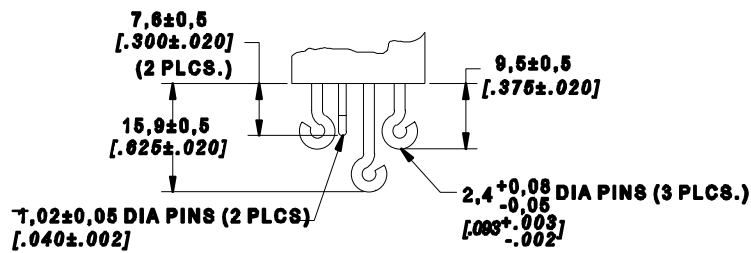

**SOLDER HOOK**

STYLE H: TIN PLATED

STYLE J: SOLDER DIPPED