

Rebling Datasheet

NON-KEYABLE RECEPTACLE SERIES

AVIONICS/MIL SPEC

To address the heightened demand in non-avionics applications for high current, high voltage DC connectors, Rebling has coupled its time-proven quick disconnect technology with commercial grade manufacturing techniques to offer a family of bulkhead-mounted receptacles with features required by OEMs in the markets we serve (motive power, stationary power, engine starting, auxiliary power and renewable power). These two pole, bulkhead-mounted receptacles are designed to mate with our commercial grade, cable-mounted plug connectors.



ELECTRICAL

Current

- ▶ Rated Current (per MIL PRF 18148)
- ▶ Peak Current

Voltage

- ▶ Rated Voltage (volts, continuous)
- ▶ Dielectric Withstanding Voltage

Contact Resistance (Micro Ohms)

MECHANICAL

Wire Size Range

- ▶ Minimum Wire Size
- ▶ Maximum Wire Size
- ▶ Maximum Cable OD (inches)
- ▶ Maximum Terminal Lug Tongue Width (inches)
- ▶ Maximum Terminal Lug Web Width (inches)

Environmental Sealing when mated

- ▶ With standard kit components
- ▶ With optional gasket

Operating Temperature

- ▶ Minimum (°C)
- ▶ Maximum (°C)

Flammability Rating (per UL Standard #94)

Mechanical Shock

Vibration

Torque on Electrical Connections

Mating Cycles

- ▶ No Electrical Load

750 amp
1,500 amp

750
2,500
60

8 AWG
4/0
1.1"
0.76"
0.22"

IP56
IP68

-40°
140°

V-0

50gs - 3 axes
10gs - 3 axes
30-40inlbs

1,500

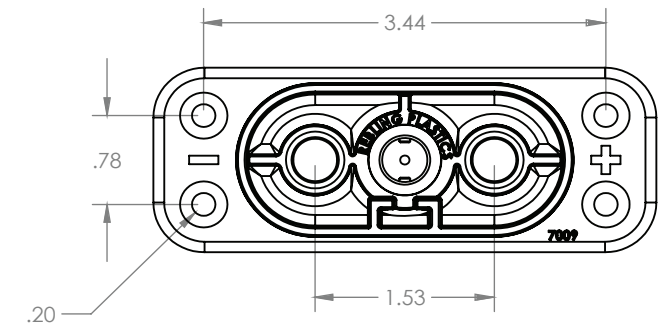
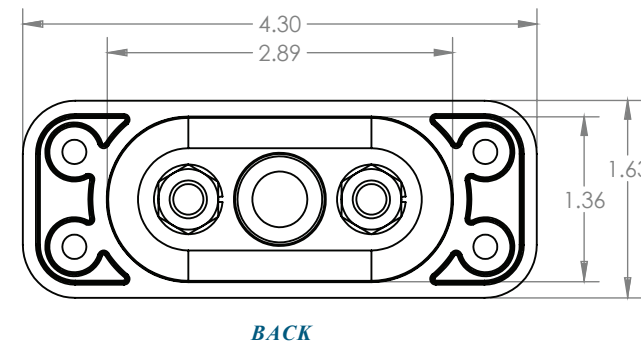
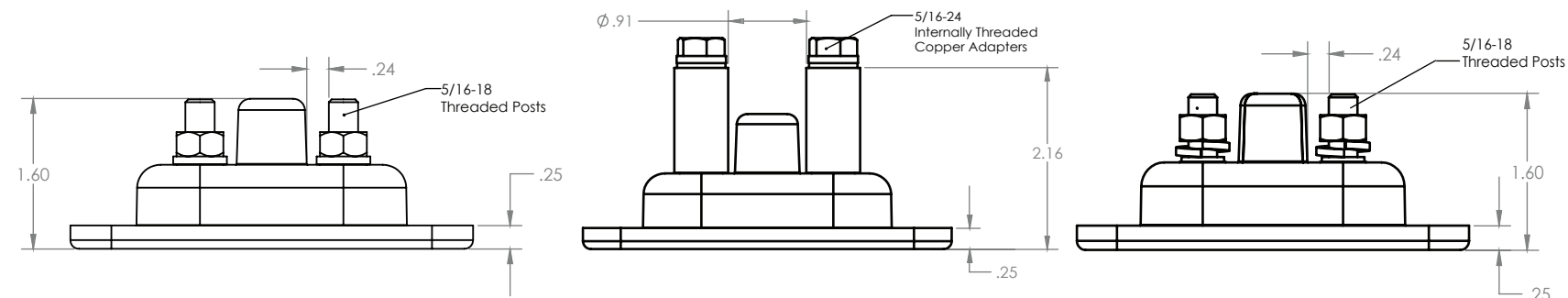
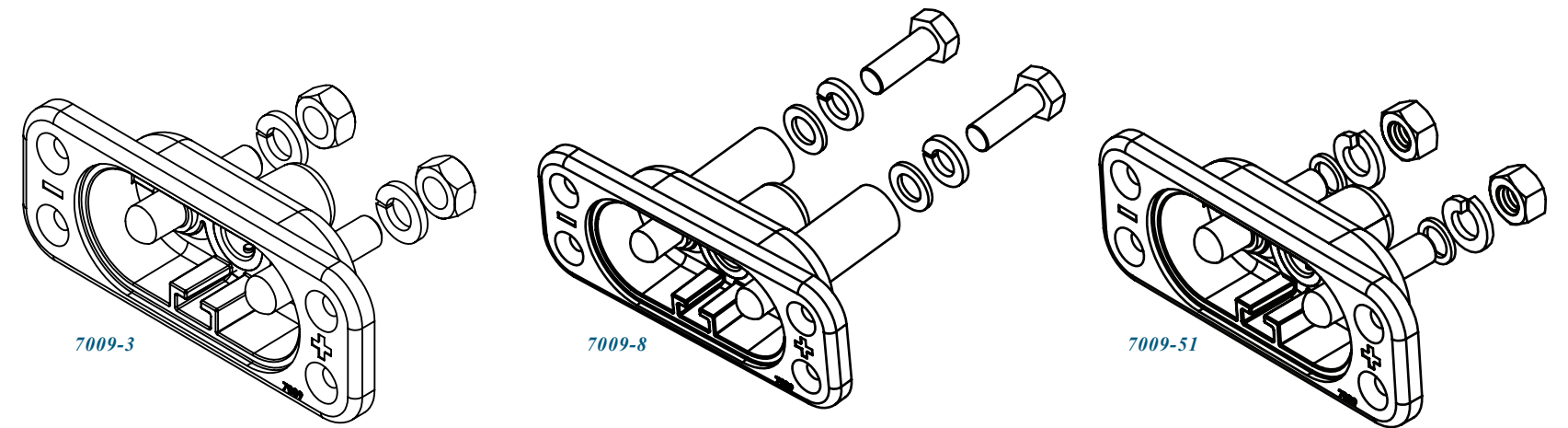

ORDERING INFORMATION

CONNECTORS

- ▶ 7009-3 Receptacle, Style 1, Threaded Posts, Black
- ▶ 7009-8 Receptacle, Style 1, Straight Adapter for oversized lugs, Brown
- ▶ 7009-51 Receptacle, Style 1, Threaded Posts, EMI Shielded, Gray

ACCESSORIES

- ▶ 700222-1 Gasket with attached Dust Cover, Black
- ▶ 643A1625 EMI conductive gasket, Flat, Black
- ▶ 644A1626 Backshell for rear of receptacle, Style 1, 3/0 or Smaller Cable
- ▶ 644A1627 Backshell for rear of 7009-8 receptacle, Style 1, 4/0 cable or larger