

| 7895 MOTOR THERMOSTATS

HERMETICALLY SEALED ON-WINDING

Construction

The basic element in the on-winding motor thermostat is the Klixon® snap-acting disc. The electrical circuit consists of the pin, insulated from the case by the glass-to-metal seal, connected to the stationary contact through the disc to the case. In the 7895 thermostat, the metal case is electrically hot and requires some method of insulation from the motor windings. Several custom configurations of insulation and terminations are available at slight additional cost.

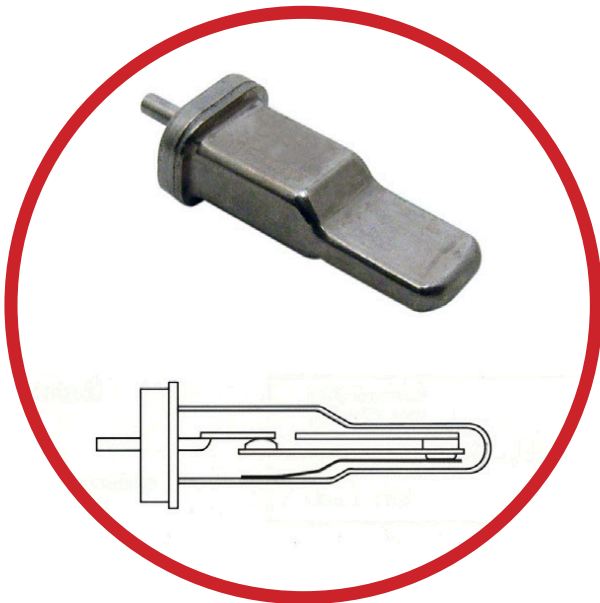

Features and Benefits

- Small size and shape permits close coupling to motor windings for increased protection
- Hermetically sealed enclosure
- Simple, rugged all-welded construction has one moving part for trouble-free service
- Klixon® snap action thermal disc assures positive make and break action controlled temperature differential and vibration resistance

Klixon® 7895 on-winding motor thermostats are designed to protect hermetically-sealed compressor motors from excessive winding temperatures. A positive refrigerant seal combined with small tubular construction allows these thermostats to be installed directly in the motor windings for precise monitoring of winding temperatures. As a result, the compressor manufacturer can choose a thermostat that will allow the motor to be safely rated to its maximum capacity.

Installation

Maximum heat transfer from the motor windings to the thermostat is the key to optimum performance. In many cases, the total surface of the device can be utilized by inserting its entire length within the stator winding. Good performance is also achieved by lacing the protector to the top of the windings, making sure that the surface of the case is in close contact with the stator windings. The thermostat may be varnished dipped and baked with the entire assembly.

Pilot Circuit Operation

The 7895 thermostat is used as a pilot duty control to protect a motor from overheating in a running overload condition. When used alone, it cannot protect against locked rotor since its response time is not fast enough to follow the very rapid temperature rise of the windings. The Klixon® 8347 and 8348 supplementary overloads with their quick response to locked rotor current, can be used to supplement the 7895 thermostat. These overload devices trip very quickly for the first several cycles, allowing enough time for the heat generated in the windings to reach the thermostat which then takes over as the controlling element. This combination is used to protect both single-phase and three-phase motors.

Performance Characteristics

Operating Temperatures	75°C to 135°C
Standard Tolerances	±5°C open, ±11°C close
Standard Differential	22°C nominal
Special Tolerances	±3°C open, ±5°C close
Special Differential	17°C nominal

Wire Lead Insulations

Dacron Mylar Dacron	600V – 105°C temperature rating – 18 AWG
Dacron Teflon Mylar Dacron	600V – 105°C temperature rating – 20 AWG
Teflon	300/600V – 200°C temperature rating – 22 AWG
Teflon	300V – 200°C temperature rating – 18 AWG

Insulation Sleeve Material

Mylar	0.004" thick
Mylar Over Teflon	0.007" thick (0.004" Mylar / 0.003" Teflon)

Terminations

Female flag quick connect 1/4" open end terminal for #10 screw, #10 eyelet
--

VDE approved
7895-XXX-XXX

$\frac{2(2)}{250} \sim \frac{1(1)}{380} \sim \frac{5.2(5.2)}{24}$

Class 1, T200



DIMENSIONS

All dimensions are in Inches (mm).

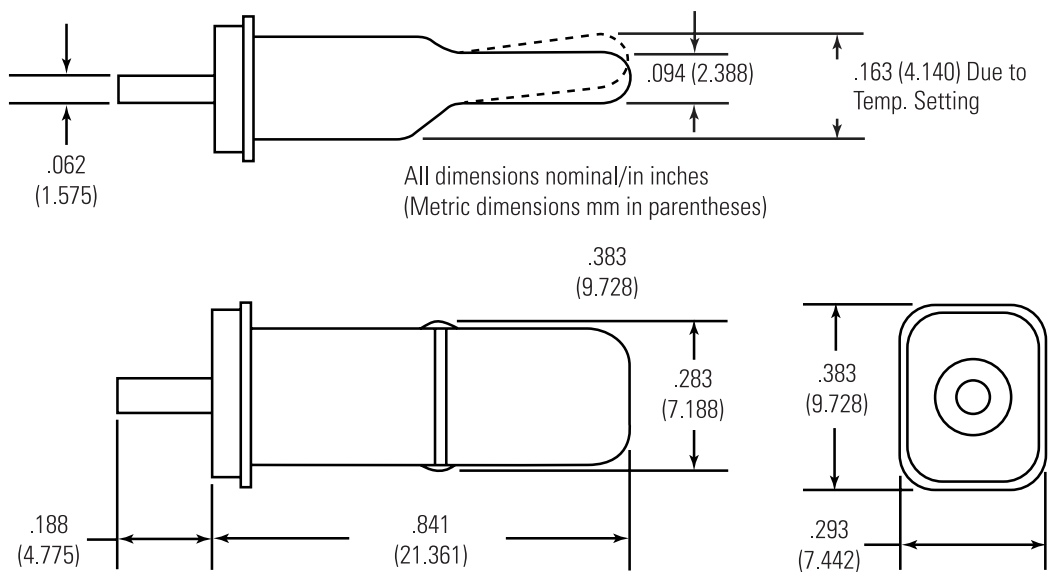



ORDERING OPTIONS

Example : 7895 - XXX - 000

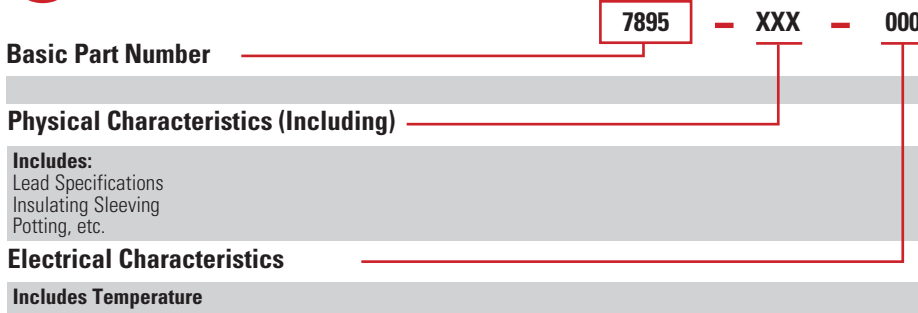

Engineering Test Samples

To order test samples please supply the following information:

1. Opening temperature
2. Temperature differential
3. Tolerances desired on opening and closing temperatures
4. Voltage
5. Lead type, size and length
6. Insulation required



AGENCY APPROVALS AND CERTIFICATIONS



UL	125 VA, 24 VAC 345 VA, 110-600 VAC
CSA	(limited to the lead wire voltage rating if less than 600 VAC).



WARNINGS



RISK OF MATERIAL DAMAGE AND HOT ENCLOSURE

- The product's side panels may be hot, allow the product to cool before touching
- Follow proper mounting instructions including torque values
- Do not allow liquids or foreign objects to enter this product

Failure to follow these instructions can result in serious injury, or equipment damage.



HAZARD OF ELECTRIC SHOCK, EXPLOSION OR ARC FLASH

- Disconnect all power before installing or working with this equipment
- Verify all connections and replace all covers before turning on power

Failure to follow these instructions will result in death or serious injury

Sensata Technologies, Inc. ("Sensata") data sheets are solely intended to assist designers ("Buyers") who are developing systems that incorporate Sensata products (also referred to herein as "components"). Buyer understands and agrees that Buyer remains responsible for using its independent analysis, evaluation and judgment in designing Buyer's systems and products. Sensata data sheets have been created using standard laboratory conditions and engineering practices. Sensata has not conducted any testing other than that specifically described in the published documentation for a particular data sheet. Sensata may make corrections, enhancements, improvements and other changes to its data sheets or components without notice.

Buyers are authorized to use Sensata data sheets with the Sensata component(s) identified in each particular data sheet. HOWEVER, NO OTHER LICENSE, EXPRESS OR IMPLIED, BY ESTOPPEL OR OTHERWISE TO ANY OTHER SENSATA INTELLECTUAL PROPERTY RIGHT, AND NO LICENSE TO ANY THIRD PARTY TECHNOLOGY OR INTELLECTUAL PROPERTY RIGHT, IS GRANTED HEREIN. SENSATA DATA SHEETS ARE PROVIDED "AS IS". SENSATA MAKES NO WARRANTIES OR REPRESENTATIONS WITH REGARD TO THE DATA SHEETS OR USE OF THE DATA SHEETS, EXPRESS, IMPLIED OR STATUTORY, INCLUDING ACCURACY OR COMPLETENESS. SENSATA DISCLAIMS ANY WARRANTY OF TITLE AND ANY IMPLIED WARRANTIES OF MERCHANTABILITY, FITNESS FOR A PARTICULAR PURPOSE, QUIET ENJOYMENT, QUIET POSSESSION, AND NON-INFRINGEMENT OF ANY THIRD PARTY INTELLECTUAL PROPERTY RIGHTS WITH REGARD TO SENSATA DATA SHEETS OR USE THEREOF.

All products are sold subject to Sensata's terms and conditions of sale supplied at www.sensata.com SENSATA ASSUMES NO LIABILITY FOR APPLICATIONS ASSISTANCE OR THE DESIGN OF BUYERS' PRODUCTS. BUYER ACKNOWLEDGES AND AGREES THAT IT IS SOLELY RESPONSIBLE FOR COMPLIANCE WITH ALL LEGAL, REGULATORY AND SAFETY-RELATED REQUIREMENTS CONCERNING ITS PRODUCTS, AND ANY USE OF SENSATA COMPONENTS IN ITS APPLICATIONS, NOTWITHSTANDING ANY APPLICATIONS-RELATED INFORMATION OR SUPPORT THAT MAY BE PROVIDED BY SENSATA.

Mailing Address: Sensata Technologies, Inc., 529 Pleasant Street, Attleboro, MA 02703, USA.

CONTACT US

Americas

+1 (508) 236 2551
electrical-protection-sales@
sensata.com

Europe, Middle East & Africa

+31 (74) 357 8156
info-sse@sensata.com

Asia Pacific

sales.isasia@list.sensata.com
China +86 (21) 2306 1500
Japan +81 (45) 277 7117
Korea +82 (31) 601 2004
India +91 (80) 67920890
Rest of Asia +886 (2) 27602006
ext 2808